



# "S" SERIES FILTER

COMMERCIAL STRENGTH POLYMER MEDIA FILTER



- ✓ One Piece Design
- ✓ Strong & Durable
- ✓ Superior Cleaning
- ✓ High Performance



## "S" SERIES FILTER

### Commercial strength polymer media filters

Thousands of installations over the last 35+ years bear testament to the quality and reliability of Poolrite "S" Series filters.

#### Features

- ✓ One piece seamless rotationally moulded tank designed for maximum strength
- ✓ Made from medium density polyethylene for strength & durability
- ✓ Clever designed dispersion inlet overdrain for smooth even flow of water into the filter tank
- ✓ Later underdrain design ensures maximum flow for fast and efficient backwashing which increases time between backwash cycles
- ✓ All non-corrosive construction suitable for all types of sanitation
- ✓ Australian design & manufacture

#### Warranty

- ✓ 10 Year filter tank
- ✓ 1 Year on all other components



Poolrite recommends using



### Dimensions

#### S-5000

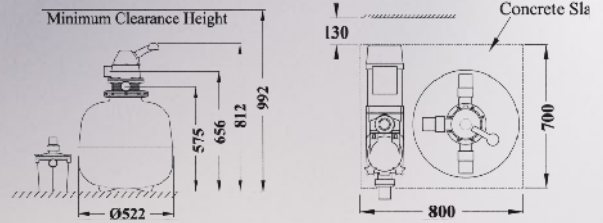

#### S-6000

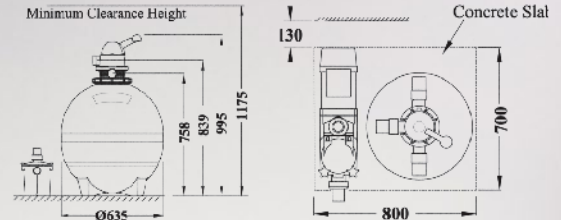

#### S-8000

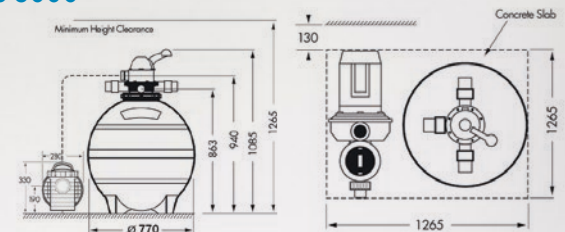

#### S-9000

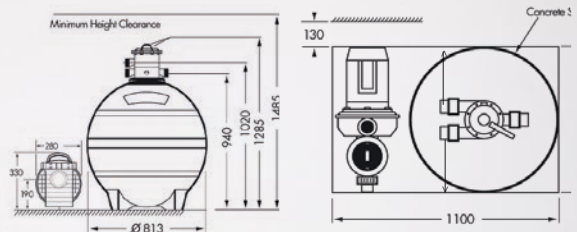

### Specifications

MODEL	S-5000	S-6000	S-8000	S-9000
Filter Tank Diameter	522mm (20 in)	635mm (25 in)	770mm (30 in)	813mm (32 in)
Max Flow Rate (L/hr)	15,000	18,000	27,000	30,000
Diamond Kleen media M10 fine (kgs)	45	90	120	150
Diamond Kleen media M20 coarse (kgs)	30	45	45	60
Recommended Pump Model	SQI-400	SQI-500 / SQI-600	SQI-600	SQI-700

Designed to suit the award winning V2000 Multiport Valve



#### Featuring

- 50mm ports and large diameter valve for greater water flow and quieter operation
- Domed top cover to prevent debris building up around valve stem for easy operation and longevity
- 50mm plumbing unions allowing quick connection and simplified servicing with reducers to 40mm
- Over moulded gaskets to prevent spider gasket blow outs



Poolrite is an Australian made and owned product of The Evolve Group of companies



See the full range of products at

[poolrite.com](http://poolrite.com)

